

SILVERTHINSM09013CP0 90 mm Open Type C Thin Section Bearing

Specifications

Bore (B)	90.000 mm
Outside Diameter (D)	116.000 mm
Width	13mm
Land Diameter (L ₁)	99.700 mm
Land Diameter (L ₂)	106.300 mm
Approximate Weight	0.29 kg
Separator	Brass; snapover separator
Precision Class	ABEC Class 1
Bearing Type	Radial Contact (Type C)
Seals, Shields	None (Open)
Unit System	Metric

Load Capacities

Static Radial Load	15,210 n
Dynamic Radial Load	9,140 n

Interchange

Silverthin

SM09013CP0

Kaydon

K09013CP0

Kaydon

K09013CP0

Brass; snapover separator
1/4" balls

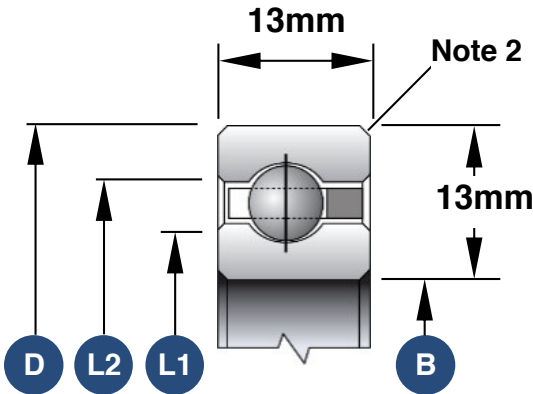

- 1. Load capacities are not additive
- 2. The maximum shaft or housing fillet radius that the bearing corners will clear for this series is 1.5mm
- 3. Race Width Tolerance: +0.000 -0.127mm

Also Available

Open Angular Contact	SM09013AR0
Open 4-Point Contact	SM09013XP0
Open Duplexed (Back-to-Back)	SM09013BR0
Open Duplexed (Face-to-Face)	SM09013FR0