

# SILVERTHIN SM10008CPO 100 mm Open Type C Thin Section Bearing

## Specifications

Bore (B)	100.000 mm
Outside Diameter (D)	116.000 mm
Width	8mm
Land Diameter (L <sub>1</sub> )	105.900 mm
Land Diameter (L <sub>2</sub> )	110.100 mm
Approximate Weight	0.14 kg
Separator	Brass; snapover separator
Precision Class	ABEC Class 1
Bearing Type	Radial Contact (Type C)
Seals, Shields	None (Open)
Unit System	Metric

## Load Capacities

Static Radial Load	10,410 n
Dynamic Radial Load	4,980 n

## Interchange

Silverthin	SM10008CPO	Kaydon	K10008CPO	Kaydon	K10008CPO
------------	------------	--------	-----------	--------	-----------

## Brass; snapover separator

5/32" balls

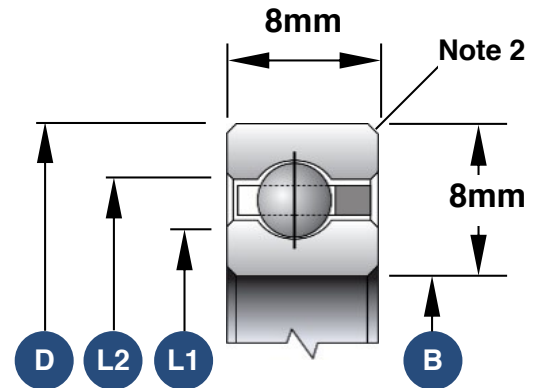

1. Load capacities are not additive
2. The maximum shaft or housing fillet radius that the bearing corners will clear for this series is 0.8mm
3. Race Width Tolerance: +0.000 -0.127mm

## Also Available

Open Angular Contact	SM10008ARO
Open 4-Point Contact	SM10008XPO
Open Duplexed (Back-to-Back)	SM10008BRO
Open Duplexed (Face-to-Face)	SM10008FRO