

# SILVERTHIN SM10013ARO

# 100 mm Open Type A Thin Section Bearing

## Specifications

Bore (B)	100.000 mm
Outside Diameter (D)	126.000 mm
Width	13mm
Land Diameter (L <sub>1</sub> )	109.700 mm
Land Diameter (L <sub>2</sub> )	116.300 mm
Land Diameter (L <sub>3</sub> )	119.600 mm
Approximate Weight	0.32 kg
Separator	Brass; one piece pocket separator
Precision Class	ABEC Class 1
Bearing Type	Angular Contact (Type A)
Seals, Shields	None (Open)
Unit System	Metric

## Load Capacities

Static Radial Load	19,215 n
Dynamic Radial Load	9,940 n
Static Thrust Load	55,465 n
Dynamic Thrust Load	22,795 n

## Interchange

Silverthin	SM10013ARO	Kaydon	K10013ARO	Kaydon	K10013ARO
------------	------------	--------	-----------	--------	-----------

## Brass; one piece pocket separator

1/4" balls

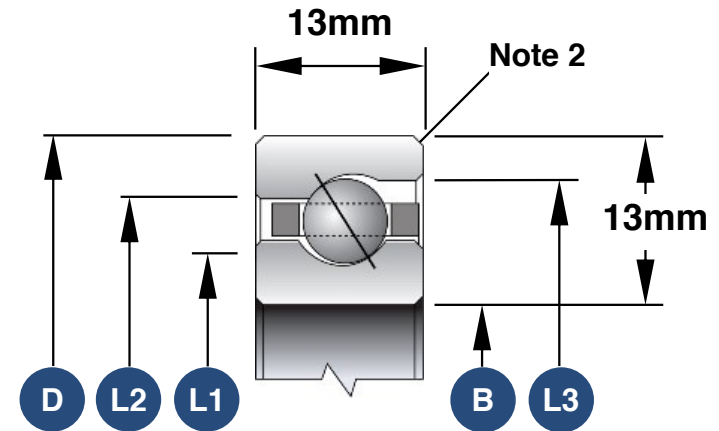

1. Load capacities are not additive
2. The maximum shaft or housing fillet radius that the bearing corners will clear for this series is 1.5mm
3. Race Width Tolerance: +0.000 -0.127mm

## Also Available

Open Radial Contact	SM10013CP0
Open 4-Point Contact	SM10013XP0
Open Duplexed (Back-to-Back)	SM10013BR0
Open Duplexed (Face-to-Face)	SM10013FR0