

# SILVERTHIN SM11020AR0 110 mm Open Type A Thin Section Bearing

## Specifications

Bore (B)	110.000 mm
Outside Diameter (D)	150.000 mm
Width	20mm
Land Diameter (L <sub>1</sub> )	125.000 mm
Land Diameter (L <sub>2</sub> )	135.000 mm
Land Diameter (L <sub>3</sub> )	140.000 mm
Approximate Weight	0.94 kg
Separator	Brass; one piece pocket separator
Precision Class	ABEC Class 1
Bearing Type	Angular Contact (Type A)
Seals, Shields	None (Open)
Unit System	Metric

## Load Capacities

Static Radial Load	34,585 n
Dynamic Radial Load	19,660 n
Static Thrust Load	99,835 n
Dynamic Thrust Load	44,190 n

## Interchange

Silverthin [SM11020AR0](#) Kaydon [K11020AR0](#) Kaydon [K11020AR0](#)

Brass; one piece pocket separator  
3/8" balls

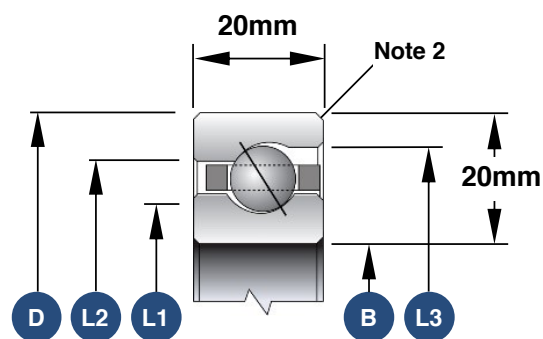

1. Load capacities are not additive
2. The maximum shaft or housing fillet radius that the bearing corners will clear for this series is 1.5mm
3. Race Width Tolerance: +0.000 -0.127mm

## Also Available

Open Radial Contact	<a href="#">SM11020CP0</a>
Open 4-Point Contact	<a href="#">SM11020XP0</a>
Open Duplexed (Back-to-Back)	<a href="#">SM11020BR0</a>
Open Duplexed (Face-to-Face)	<a href="#">SM11020FR0</a>