

SILVERTHIN SM11020XP0 110 mm Open Type X Thin Section Bearing

Specifications

Bore (B)	110.000 mm
Outside Diameter (D)	150.000 mm
Width	20mm
Land Diameter (L ₁)	125.000 mm
Land Diameter (L ₂)	135.000 mm
Approximate Weight	0.94 kg
Separator	Brass; snapover separator
Precision Class	ABEC Class 1
Bearing Type	4-Point Contact (Type X)
Seals, Shields	None (Open)
Unit System	Metric

Load Capacities

Static Radial Load	28,535 n
Dynamic Radial Load	24,175 n
Static Thrust Load	71,300 n
Dynamic Thrust Load	35,315 n
Static Moment Load	1,855 N-m
Dynamic Moment Load	1,180 N-m

Interchange

Silverthin [SM11020XP0](#)Kaydon [K11020XP0](#)Kaydon [K11020XP0](#)

Brass; snapover separator

3/8" balls

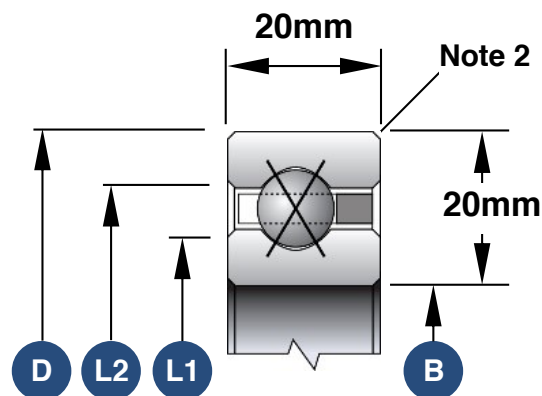

1. Load capacities are not additive
2. The maximum shaft or housing fillet radius that the bearing corners will clear for this series is 1.5mm
3. Race Width Tolerance: +0.000 -0.127mm

Also Available

Open Angular Contact	SM11020AR0
Open Radial Contact	SM11020CP0
Open Duplexed (Back-to-Back)	SM11020BR0
Open Duplexed (Face-to-Face)	SM11020FR0

866.294.5841

425.222.7535

sales@silverthin.com

8152 - 304th Ave. S.E. PO Box 5012 Preston, WA 98050-5012 USA

Copyright © 2024 All rights reserved by Silverthin