

SILVERTHIN SM12013ARO

120 mm Open Type A Thin Section Bearing

Specifications

Bore (B)	120.000 mm
Outside Diameter (D)	146.000 mm
Width	13mm
Land Diameter (L ₁)	129.700 mm
Land Diameter (L ₂)	136.300 mm
Land Diameter (L ₃)	139.600 mm
Approximate Weight	0.38 kg
Separator	Brass; one piece pocket separator
Precision Class	ABEC Class 1
Bearing Type	Angular Contact (Type A)
Seals, Shields	None (Open)
Unit System	Metric

Load Capacities

Static Radial Load	22,505 n
Dynamic Radial Load	10,875 n
Static Thrust Load	64,965 n
Dynamic Thrust Load	25,330 n

Interchange

Silverthin	SM12013ARO	Kaydon	K12013ARO	Kaydon	K12013ARO
------------	------------	--------	-----------	--------	-----------

Brass; one piece pocket separator

1/4" balls

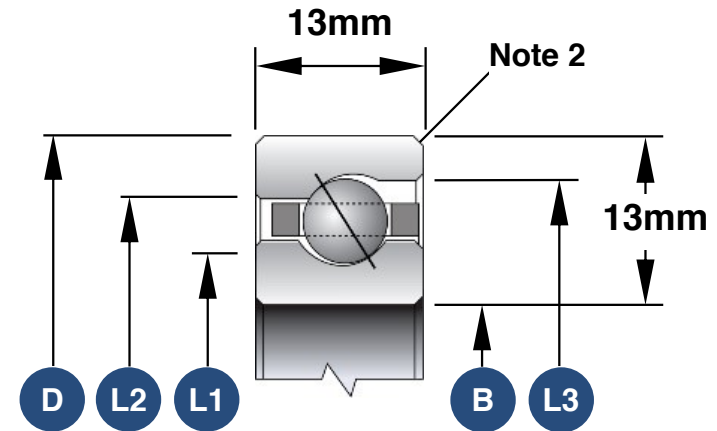

1. Load capacities are not additive
2. The maximum shaft or housing fillet radius that the bearing corners will clear for this series is 1.5mm
3. Race Width Tolerance: +0.000 -0.127mm

Also Available

Open Radial Contact	SM12013CP0
Open 4-Point Contact	SM12013XP0
Open Duplexed (Back-to-Back)	SM12013BR0
Open Duplexed (Face-to-Face)	SM12013FR0