

SILVERTHIN SM12013CP0 120 mm Open Type C Thin Section Bearing

Specifications

Bore (B)	120.000 mm
Outside Diameter (D)	146.000 mm
Width	13mm
Land Diameter (L ₁)	129.700 mm
Land Diameter (L ₂)	136.300 mm
Approximate Weight	0.38 kg
Separator	Brass; snapover separator
Precision Class	ABEC Class 1
Bearing Type	Radial Contact (Type C)
Seals, Shields	None (Open)
Unit System	Metric

Load Capacities

Static Radial Load	19,660 n
Dynamic Radial Load	10,520 n

Interchange

Silverthin [SM12013CP0](#) Kaydon [K12013CP0](#) Kaydon [K12013CP0](#)

Brass; snapover separator

1/4" balls

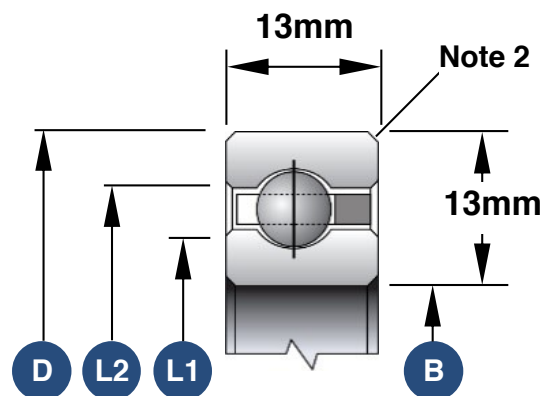

1. Load capacities are not additive
2. The maximum shaft or housing fillet radius that the bearing corners will clear for this series is 1.5mm
3. Race Width Tolerance: +0.000 -0.127mm

Also Available

Open Angular Contact	SM12013AR0
Open 4-Point Contact	SM12013XP0
Open Duplexed (Back-to-Back)	SM12013BR0
Open Duplexed (Face-to-Face)	SM12013FR0

866.294.5841

425.222.7535

sales@silverthin.com

8152 - 304th Ave. S.E. PO Box 5012 Preston, WA 98050-5012 USA

Copyright © 2024 All rights reserved by Silverthin