

# SILVERTHIN SM12020CP0 120 mm Open Type C Thin Section Bearing

## Specifications

Bore (B)	120.000 mm
Outside Diameter (D)	160.000 mm
Width	20mm
Land Diameter (L <sub>1</sub> )	135.000 mm
Land Diameter (L <sub>2</sub> )	145.000 mm
Approximate Weight	1.01 kg
Separator	Brass; snapover separator
Precision Class	ABEC Class 1
Bearing Type	Radial Contact (Type C)
Seals, Shields	None (Open)
Unit System	Metric

## Load Capacities

Static Radial Load	31,380 n
Dynamic Radial Load	19,440 n

## Interchange

Silverthin [SM12020CP0](#) Kaydon [K12020CP0](#) Kaydon [K12020CP0](#)

## Brass; snapover separator

3/8" balls

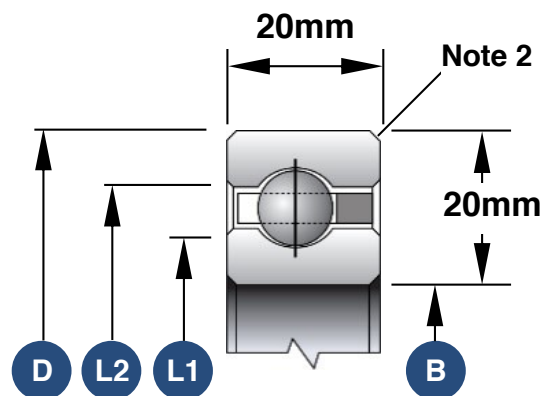

1. Load capacities are not additive
2. The maximum shaft or housing fillet radius that the bearing corners will clear for this series is 1.5mm
3. Race Width Tolerance: +0.000 -0.127mm

## Also Available

Open Angular Contact	<a href="#">SM12020AR0</a>
Open 4-Point Contact	<a href="#">SM12020XP0</a>
Open Duplexed (Back-to-Back)	<a href="#">SM12020BR0</a>
Open Duplexed (Face-to-Face)	<a href="#">SM12020FR0</a>