

SILVERTHIN SM13013CP0 130 mm Open Type C Thin Section Bearing

Specifications

Bore (B)	130.000 mm
Outside Diameter (D)	156.000 mm
Width	13mm
Land Diameter (L ₁)	139.700 mm
Land Diameter (L ₂)	146.300 mm
Approximate Weight	0.41 kg
Separator	Brass; snapover separator
Precision Class	ABEC Class 1
Bearing Type	Radial Contact (Type C)
Seals, Shields	None (Open)
Unit System	Metric

Load Capacities

Static Radial Load	20,930 n
Dynamic Radial Load	10,875 n

Interchange

Silverthin [SM13013CP0](#) Kaydon [K13013CP0](#) Kaydon [K13013CP0](#)

Brass; snapover separator

1/4" balls

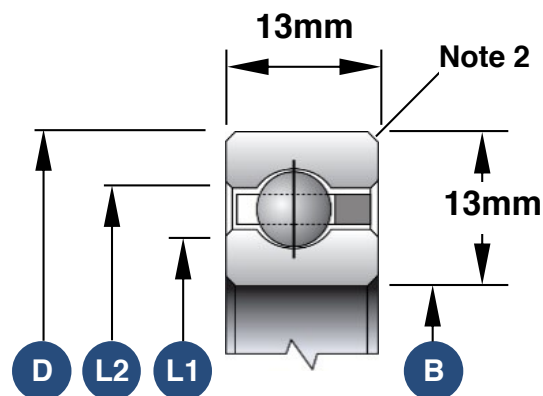

1. Load capacities are not additive
2. The maximum shaft or housing fillet radius that the bearing corners will clear for this series is 1.5mm
3. Race Width Tolerance: +0.000 -0.127mm

Also Available

Open Angular Contact	SM13013AR0
Open 4-Point Contact	SM13013XP0
Open Duplexed (Back-to-Back)	SM13013BR0
Open Duplexed (Face-to-Face)	SM13013FR0