

SILVERTHIN SM14008CPO 140 mm Open Type C Thin Section Bearing

Specifications

Bore (B)	140.000 mm
Outside Diameter (D)	156.000 mm
Width	8mm
Land Diameter (L ₁)	145.900 mm
Land Diameter (L ₂)	150.100 mm
Approximate Weight	0.18 kg
Separator	Brass; snapover separator
Precision Class	ABEC Class 1
Bearing Type	Radial Contact (Type C)
Seals, Shields	None (Open)
Unit System	Metric

Load Capacities

Static Radial Load	14,365 n
Dynamic Radial Load	6,005 n

Interchange

Silverthin	SM14008CPO	Kaydon	K14008CPO	Kaydon	K14008CPO
------------	------------	--------	-----------	--------	-----------

Brass; snapover separator

5/32" balls

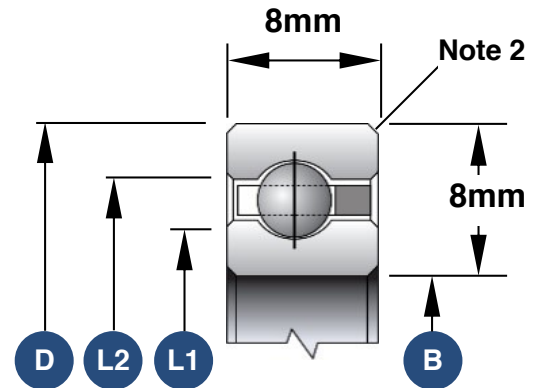

1. Load capacities are not additive
2. The maximum shaft or housing fillet radius that the bearing corners will clear for this series is 0.8mm
3. Race Width Tolerance: +0.000 -0.127mm

Also Available

Open Angular Contact	SM14008ARO
Open 4-Point Contact	SM14008XPO
Open Duplexed (Back-to-Back)	SM14008BR0
Open Duplexed (Face-to-Face)	SM14008FR0