

# SILVERTHIN SM14013CP0 140 mm Open Type C Thin Section Bearing

## Specifications

Bore (B)	140.000 mm
Outside Diameter (D)	166.000 mm
Width	13mm
Land Diameter (L <sub>1</sub> )	149.700 mm
Land Diameter (L <sub>2</sub> )	156.300 mm
Approximate Weight	0.44 kg
Separator	Brass; snapover separator
Precision Class	ABEC Class 1
Bearing Type	Radial Contact (Type C)
Seals, Shields	None (Open)
Unit System	Metric

## Load Capacities

Static Radial Load	22,820 n
Dynamic Radial Load	11,455 n

## Interchange

Silverthin [SM14013CP0](#) Kaydon [K14013CP0](#) Kaydon [K14013CPO](#)

## Brass; snapover separator

1/4" balls

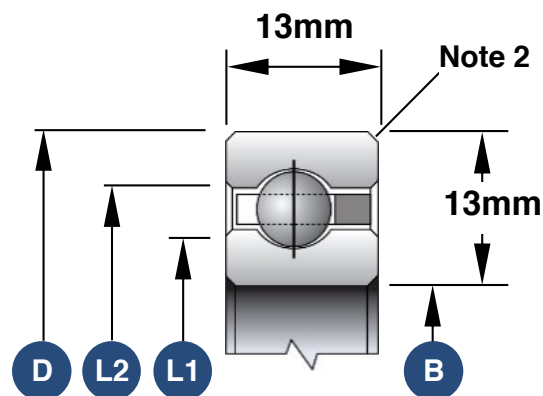

1. Load capacities are not additive
2. The maximum shaft or housing fillet radius that the bearing corners will clear for this series is 1.5mm
3. Race Width Tolerance: +0.000 -0.127mm

## Also Available

Open Angular Contact	<a href="#">SM14013AR0</a>
Open 4-Point Contact	<a href="#">SM14013XP0</a>
Open Duplexed (Back-to-Back)	<a href="#">SM14013BR0</a>
Open Duplexed (Face-to-Face)	<a href="#">SM14013FR0</a>