

SILVERTHIN SM14020AR0 140 mm Open Type A Thin Section Bearing

Specifications

Bore (B)	140.000 mm
Outside Diameter (D)	180.000 mm
Width	20mm
Land Diameter (L ₁)	155.000 mm
Land Diameter (L ₂)	165.000 mm
Land Diameter (L ₃)	170.000 mm
Approximate Weight	1.15 kg
Separator	Brass; one piece pocket separator
Precision Class	ABEC Class 1
Bearing Type	Angular Contact (Type A)
Seals, Shields	None (Open)
Unit System	Metric

Load Capacities

Static Radial Load	41,990 n
Dynamic Radial Load	21,840 n
Static Thrust Load	121,230 n
Dynamic Thrust Load	50,305 n

Interchange

Silverthin [SM14020AR0](#) Kaydon [K14020AR0](#) Kaydon [K14020AR0](#)

Brass; one piece pocket separator
3/8" balls

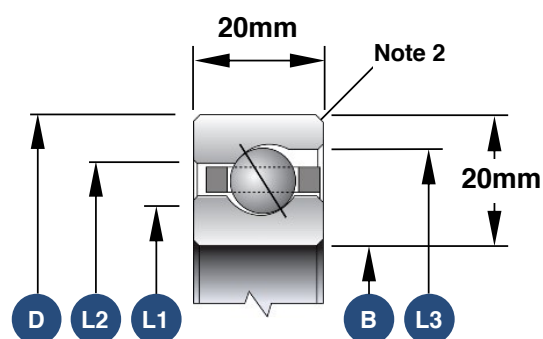

1. Load capacities are not additive
2. The maximum shaft or housing fillet radius that the bearing corners will clear for this series is 1.5mm
3. Race Width Tolerance: +0.000 -0.127mm

Also Available

Open Radial Contact	SM14020CP0
Open 4-Point Contact	SM14020XP0
Open Duplexed (Back-to-Back)	SM14020BR0
Open Duplexed (Face-to-Face)	SM14020FR0