

SILVERTHIN SM14020CP0 140 mm Open Type C Thin Section Bearing

Specifications

| | |
|---------------------------------|---------------------------|
| Bore (B) | 140.000 mm |
| Outside Diameter (D) | 180.000 mm |
| Width | 20mm |
| Land Diameter (L ₁) | 155.000 mm |
| Land Diameter (L ₂) | 165.000 mm |
| Approximate Weight | 1.15 kg |
| Separator | Brass; snapover separator |
| Precision Class | ABEC Class 1 |
| Bearing Type | Radial Contact (Type C) |
| Seals, Shields | None (Open) |
| Unit System | Metric |

Load Capacities

| | |
|---------------------|----------|
| Static Radial Load | 35,650 n |
| Dynamic Radial Load | 20,795 n |

Interchange

Silverthin [SM14020CP0](#) Kaydon [K14020CP0](#) Kaydon [K14020CP0](#)

Brass; snapover separator

3/8" balls

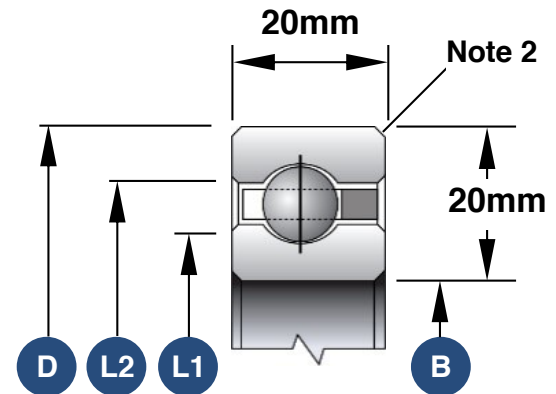

1. Load capacities are not additive
2. The maximum shaft or housing fillet radius that the bearing corners will clear for this series is 1.5mm
3. Race Width Tolerance: +0.000 -0.127mm

Also Available

| | |
|------------------------------|----------------------------|
| Open Angular Contact | SM14020AR0 |
| Open 4-Point Contact | SM14020XP0 |
| Open Duplexed (Back-to-Back) | SM14020BR0 |
| Open Duplexed (Face-to-Face) | SM14020FR0 |