

SILVERTHIN SM14020XP0 140 mm Open Type X Thin Section Bearing

Specifications

Bore (B)	140.000 mm
Outside Diameter (D)	180.000 mm
Width	20mm
Land Diameter (L ₁)	155.000 mm
Land Diameter (L ₂)	165.000 mm
Approximate Weight	1.15 kg
Separator	Brass; snapover separator
Precision Class	ABEC Class 1
Bearing Type	4-Point Contact (Type X)
Seals, Shields	None (Open)
Unit System	Metric

Load Capacities

Static Radial Load	35,650 n
Dynamic Radial Load	27,375 n
Static Thrust Load	89,140 n
Dynamic Thrust Load	40,990 n
Static Moment Load	2,850 N-m
Dynamic Moment Load	1,645 N-m

Interchange

Silverthin [SM14020XP0](#) Kaydon [K14020XP0](#) Kaydon [K14020XP0](#)

Brass; snapover separator

3/8" balls

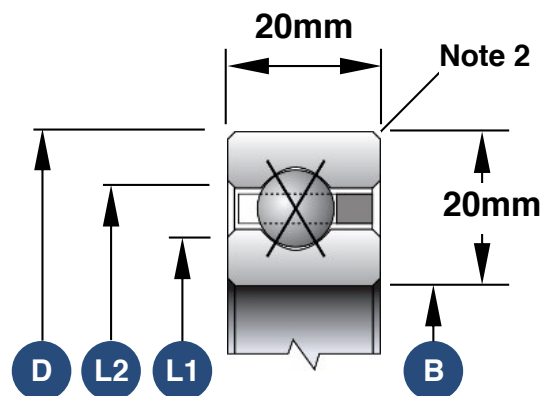

1. Load capacities are not additive
2. The maximum shaft or housing fillet radius that the bearing corners will clear for this series is 1.5mm
3. Race Width Tolerance: +0.000 -0.127mm

Also Available

Open Angular Contact	SM14020AR0
Open Radial Contact	SM14020CP0
Open Duplexed (Back-to-Back)	SM14020BR0
Open Duplexed (Face-to-Face)	SM14020FR0