

# SILVERTHIN SM16020AR0 160 mm Open Type A Thin Section Bearing

## Specifications

Bore (B)	160.000 mm
Outside Diameter (D)	200.000 mm
Width	20mm
Land Diameter (L <sub>1</sub> )	175.000 mm
Land Diameter (L <sub>2</sub> )	185.000 mm
Land Diameter (L <sub>3</sub> )	190.000 mm
Approximate Weight	1.30 kg
Separator	Brass; one piece pocket separator
Precision Class	ABEC Class 1
Bearing Type	Angular Contact (Type A)
Seals, Shields	None (Open)
Unit System	Metric

## Load Capacities

Static Radial Load	48,170 n
Dynamic Radial Load	23,595 n
Static Thrust Load	139,045 n
Dynamic Thrust Load	55,110 n

## Interchange

Silverthin [SM16020AR0](#) Kaydon [K16020AR0](#) Kaydon [K16020AR0](#)

Brass; one piece pocket separator  
3/8" balls

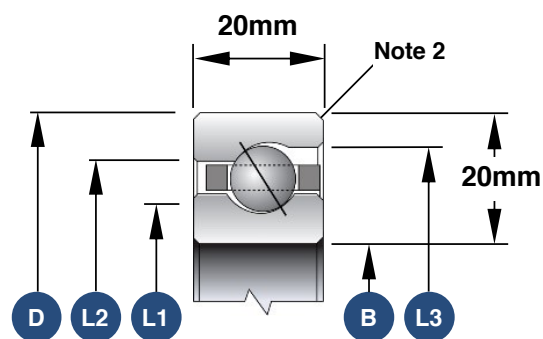

1. Load capacities are not additive
2. The maximum shaft or housing fillet radius that the bearing corners will clear for this series is 1.5mm
3. Race Width Tolerance: +0.000 -0.127mm

## Also Available

Open Radial Contact	<a href="#">SM16020CP0</a>
Open 4-Point Contact	<a href="#">SM16020XP0</a>
Open Duplexed (Back-to-Back)	<a href="#">SM16020BR0</a>
Open Duplexed (Face-to-Face)	<a href="#">SM16020FR0</a>