

SILVERTHIN SM17020AR0 170 mm Open Type A Thin Section Bearing

Specifications

Bore (B)	170.000 mm
Outside Diameter (D)	210.000 mm
Width	20mm
Land Diameter (L ₁)	185.000 mm
Land Diameter (L ₂)	195.000 mm
Land Diameter (L ₃)	200.000 mm
Approximate Weight	1.40 kg
Separator	Brass; one piece pocket separator
Precision Class	ABEC Class 1
Bearing Type	Angular Contact (Type A)
Seals, Shields	None (Open)
Unit System	Metric

Load Capacities

Static Radial Load	50,465 n
Dynamic Radial Load	24,265 n
Static Thrust Load	146,185 n
Dynamic Thrust Load	56,980 n

Interchange

Silverthin [SM17020AR0](#) Kaydon [K17020AR0](#) Kaydon [K17020AR0](#)

Brass; one piece pocket separator
3/8" balls

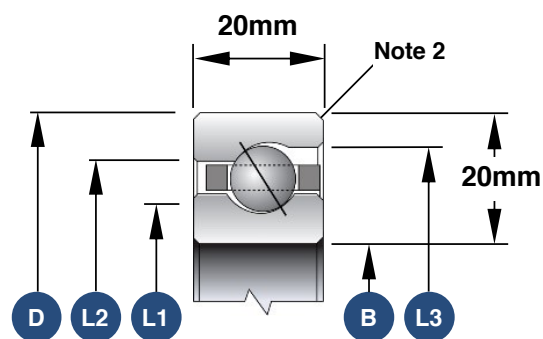

1. Load capacities are not additive
2. The maximum shaft or housing fillet radius that the bearing corners will clear for this series is 1.5mm
3. Race Width Tolerance: +0.000 -0.127mm

Also Available

Open Radial Contact	SM17020CP0
Open 4-Point Contact	SM17020XP0
Open Duplexed (Back-to-Back)	SM17020BR0
Open Duplexed (Face-to-Face)	SM17020FR0