

SILVERTHIN SM17020XP0 170 mm Open Type X Thin Section Bearing

Specifications

Bore (B)	170.000 mm
Outside Diameter (D)	210.000 mm
Width	20mm
Land Diameter (L ₁)	185.000 mm
Land Diameter (L ₂)	195.000 mm
Approximate Weight	1.40 kg
Separator	Brass; snapover separator
Precision Class	ABEC Class 1
Bearing Type	4-Point Contact (Type X)
Seals, Shields	None (Open)
Unit System	Metric

Load Capacities

Static Radial Load	42,790 n
Dynamic Radial Load	29,645 n
Static Thrust Load	106,950 n
Dynamic Thrust Load	46,280 n
Static Moment Load	3,930 N-m
Dynamic Moment Load	2,115 N-m

Interchange

Silverthin [SM17020XP0](#)Kaydon [K17020XP0](#)Kaydon [K17020XP0](#)

Brass; snapover separator

3/8" balls

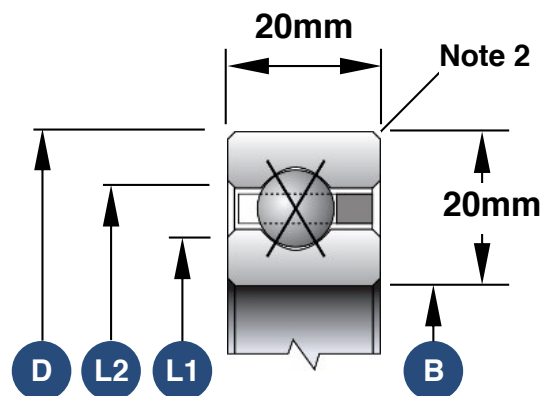

1. Load capacities are not additive
2. The maximum shaft or housing fillet radius that the bearing corners will clear for this series is 1.5mm
3. Race Width Tolerance: +0.000 -0.127mm

Also Available

Open Angular Contact	SM17020AR0
Open Radial Contact	SM17020CP0
Open Duplexed (Back-to-Back)	SM17020BR0
Open Duplexed (Face-to-Face)	SM17020FR0