

# SILVERTHIN SM19020XP0 190 mm Open Type X Thin Section Bearing

## Specifications

Bore (B)	190.000 mm
Outside Diameter (D)	230.000 mm
Width	20mm
Land Diameter (L <sub>1</sub> )	205.000 mm
Land Diameter (L <sub>2</sub> )	215.000 mm
Approximate Weight	1.50 kg
Separator	Brass; snapover separator
Precision Class	ABEC Class 1
Bearing Type	4-Point Contact (Type X)
Seals, Shields	None (Open)
Unit System	Metric

## Load Capacities

Static Radial Load	47,060 n
Dynamic Radial Load	31,960 n
Static Thrust Load	117,670 n
Dynamic Thrust Load	49,305 n
Static Moment Load	4,940 N-m
Dynamic Moment Load	2,520 N-m

## Interchange

Silverthin [SM19020XP0](#) Kaydon [K19020XP0](#) Kaydon [K19020XP0](#)

## Brass; snapover separator

3/8" balls

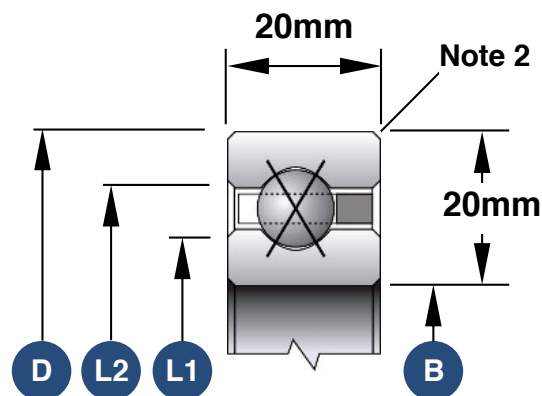

1. Load capacities are not additive
2. The maximum shaft or housing fillet radius that the bearing corners will clear for this series is 1.5mm
3. Race Width Tolerance: +0.000 -0.127mm

## Also Available

Open Angular Contact	<a href="#">SM19020AR0</a>
Open Radial Contact	<a href="#">SM19020CP0</a>
Open Duplexed (Back-to-Back)	<a href="#">SM19020BR0</a>
Open Duplexed (Face-to-Face)	<a href="#">SM19020FR0</a>

866.294.5841

425.222.7535

sales@silverthin.com

8152 - 304th Ave. S.E. PO Box 5012 Preston, WA 98050-5012 USA

Copyright © 2024 All rights reserved by Silverthin