

# SILVERTHIN SM20013CP0 200 mm Open Type C Thin Section Bearing

## Specifications

Bore (B)	200.000 mm
Outside Diameter (D)	226.000 mm
Width	13mm
Land Diameter (L <sub>1</sub> )	209.700 mm
Land Diameter (L <sub>2</sub> )	216.300 mm
Approximate Weight	0.61 kg
Separator	Brass; snapover separator
Precision Class	ABEC Class 1
Bearing Type	Radial Contact (Type C)
Seals, Shields	None (Open)
Unit System	Metric

## Load Capacities

Static Radial Load	31,690 n
Dynamic Radial Load	13,835 n

## Interchange

Silverthin [SM20013CP0](#) Kaydon [K20013CP0](#) Kaydon [K20013CP0](#)

## Brass; snapover separator

1/4" balls

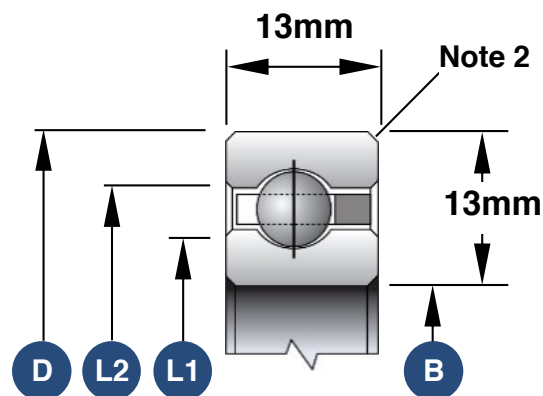

1. Load capacities are not additive
2. The maximum shaft or housing fillet radius that the bearing corners will clear for this series is 1.5mm
3. Race Width Tolerance: +0.000 -0.127mm

## Also Available

Open Angular Contact	<a href="#">SM20013AR0</a>
Open 4-Point Contact	<a href="#">SM20013XP0</a>
Open Duplexed (Back-to-Back)	<a href="#">SM20013BR0</a>
Open Duplexed (Face-to-Face)	<a href="#">SM20013FR0</a>