

SILVERTHIN SM25020AR0 250 mm Open Type A Thin Section Bearing

Specifications

Bore (B)	250.000 mm
Outside Diameter (D)	290.000 mm
Width	20mm
Land Diameter (L ₁)	265.000 mm
Land Diameter (L ₂)	275.000 mm
Land Diameter (L ₃)	280.000 mm
Approximate Weight	2.10 kg
Separator	Brass; one piece pocket separator
Precision Class	ABEC Class 1
Bearing Type	Angular Contact (Type A)
Seals, Shields	None (Open)
Unit System	Metric

Load Capacities

Static Radial Load	72,880 n
Dynamic Radial Load	29,825 n
Static Thrust Load	210,370 n
Dynamic Thrust Load	72,635 n

Interchange

Silverthin [SM25020AR0](#) Kaydon [K25020AR0](#) Kaydon [K25020AR0](#)

Brass; one piece pocket separator
3/8" balls

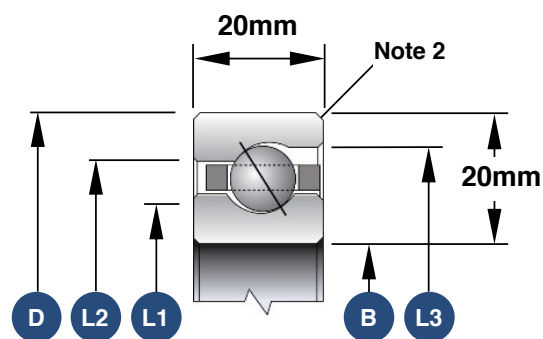

1. Load capacities are not additive
2. The maximum shaft or housing fillet radius that the bearing corners will clear for this series is 1.5mm
3. Race Width Tolerance: +0.000 -0.127mm

Also Available

Open Radial Contact	SM25020CP0
Open 4-Point Contact	SM25020XP0
Open Duplexed (Back-to-Back)	SM25020BR0
Open Duplexed (Face-to-Face)	SM25020FR0