

SILVERTHIN SM32008CPO 320 mm Open Type C Thin Section Bearing

Specifications

Bore (B)	320.000 mm
Outside Diameter (D)	336.000 mm
Width	8mm
Land Diameter (L ₁)	325.900 mm
Land Diameter (L ₂)	330.100 mm
Approximate Weight	0.36 kg
Separator	Brass; snapover separator
Precision Class	ABEC Class 1
Bearing Type	Radial Contact (Type C)
Seals, Shields	None (Open)
Unit System	Metric

Load Capacities

Static Radial Load	31,935 n
Dynamic Radial Load	9,650 n

Interchange

Silverthin [SM32008CPO](#) Kaydon [K32008CPO](#) Kaydon [K32008CPO](#)

Brass; snapover separator

5/32" balls

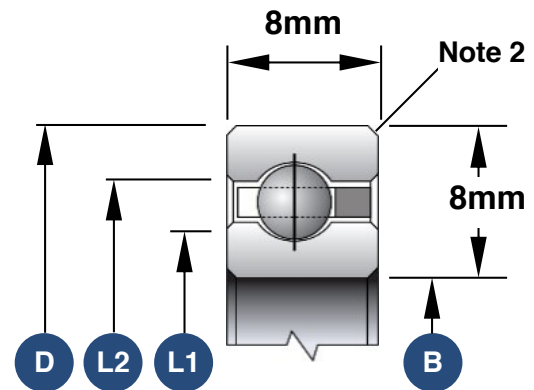

1. Load capacities are not additive
2. The maximum shaft or housing fillet radius that the bearing corners will clear for this series is 0.8mm
3. Race Width Tolerance: +0.000 -0.127mm

Also Available

Open Angular Contact	SM32008ARO
Open 4-Point Contact	SM32008XPO
Open Duplexed (Back-to-Back)	SM32008BRO
Open Duplexed (Face-to-Face)	SM32008FRO