

SILVERTHIN SM32020AR0 320 mm Open Type A Thin Section Bearing

Specifications

Bore (B)	320.000 mm
Outside Diameter (D)	360.000 mm
Width	20mm
Land Diameter (L ₁)	335.000 mm
Land Diameter (L ₂)	345.000 mm
Land Diameter (L ₃)	350.000 mm
Approximate Weight	2.42 kg
Separator	Brass; one piece pocket separator
Precision Class	ABEC Class 1
Bearing Type	Angular Contact (Type A)
Seals, Shields	None (Open)
Unit System	Metric

Load Capacities

Static Radial Load	91,405 n
Dynamic Radial Load	33,870 n
Static Thrust Load	263,855 n
Dynamic Thrust Load	84,490 n

Interchange

Silverthin [SM32020AR0](#) Kaydon [K32020AR0](#) Kaydon [K32020AR0](#)

Brass; one piece pocket separator
3/8" balls

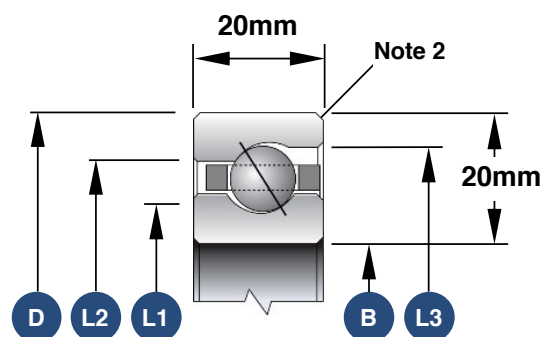

1. Load capacities are not additive
2. The maximum shaft or housing fillet radius that the bearing corners will clear for this series is 1.5mm
3. Race Width Tolerance: +0.000 -0.127mm

Also Available

Open Radial Contact	SM32020CP0
Open 4-Point Contact	SM32020XP0
Open Duplexed (Back-to-Back)	SM32020BR0
Open Duplexed (Face-to-Face)	SM32020FR0