

# SILVERTHIN SM32020XP0 320 mm Open Type X Thin Section Bearing

## Specifications

Bore (B)	320.000 mm
Outside Diameter (D)	360.000 mm
Width	20mm
Land Diameter (L <sub>1</sub> )	335.000 mm
Land Diameter (L <sub>2</sub> )	345.000 mm
Approximate Weight	2.42 kg
Separator	Brass; snapover separator
Precision Class	ABEC Class 1
Bearing Type	4-Point Contact (Type X)
Seals, Shields	None (Open)
Unit System	Metric

## Load Capacities

Static Radial Load	75,595 n
Dynamic Radial Load	41,720 n
Static Thrust Load	188,975 n
Dynamic Thrust Load	67,630 n
Static Moment Load	12,850 N-m
Dynamic Moment Load	5,325 N-m

## Interchange

Silverthin [SM32020XP0](#) Kaydon [K32020XP0](#) Kaydon [K32020XP0](#)

## Brass; snapover separator

3/8" balls

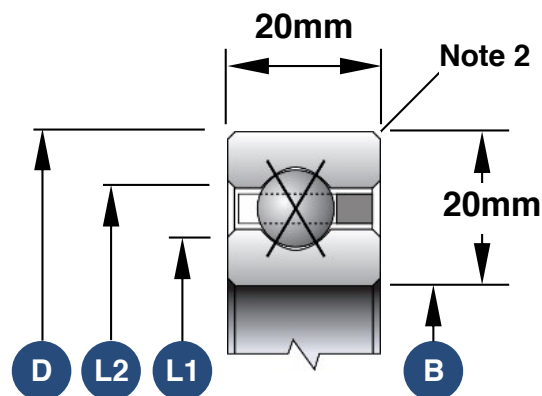

1. Load capacities are not additive
2. The maximum shaft or housing fillet radius that the bearing corners will clear for this series is 1.5mm
3. Race Width Tolerance: +0.000 -0.127mm

## Also Available

Open Angular Contact	<a href="#">SM32020AR0</a>
Open Radial Contact	<a href="#">SM32020CP0</a>
Open Duplexed (Back-to-Back)	<a href="#">SM32020BR0</a>
Open Duplexed (Face-to-Face)	<a href="#">SM32020FR0</a>