

# SILVERTHIN SM36008CPO 360 mm Open Type C Thin Section Bearing

## Specifications

Bore (B)	360.000 mm
Outside Diameter (D)	376.000 mm
Width	8mm
Land Diameter (L <sub>1</sub> )	365.900 mm
Land Diameter (L <sub>2</sub> )	370.100 mm
Approximate Weight	0.40 kg
Separator	Brass; snapover separator
Precision Class	ABEC Class 1
Bearing Type	Radial Contact (Type C)
Seals, Shields	None (Open)
Unit System	Metric

## Load Capacities

Static Radial Load	35,650 n
Dynamic Radial Load	10,295 n

## Interchange

Silverthin **SM36008CPO** Kaydon **K36008CPO** Kaydon **K36008CPO**

## Brass; snapover separator

5/32" balls

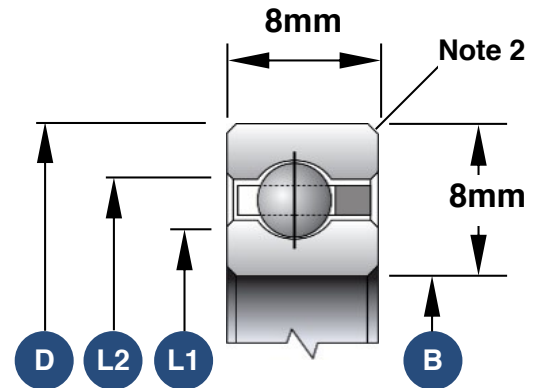

1. Load capacities are not additive
2. The maximum shaft or housing fillet radius that the bearing corners will clear for this series is 0.8mm
3. Race Width Tolerance: +0.000 -0.127mm

## Also Available

Open Angular Contact	<b>SM36008ARO</b>
Open 4-Point Contact	<b>SM36008XPO</b>
Open Duplexed (Back-to-Back)	<b>SM36008BRO</b>
Open Duplexed (Face-to-Face)	<b>SM36008FRO</b>