

SILVERTHIN SM36013CP0 360 mm Open Type C Thin Section Bearing

Specifications

| | |
|---------------------------------|---------------------------|
| Bore (B) | 360.000 mm |
| Outside Diameter (D) | 386.000 mm |
| Width | 13mm |
| Land Diameter (L ₁) | 369.700 mm |
| Land Diameter (L ₂) | 376.300 mm |
| Approximate Weight | 1.06 kg |
| Separator | Brass; snapover separator |
| Precision Class | ABEC Class 1 |
| Bearing Type | Radial Contact (Type C) |
| Seals, Shields | None (Open) |
| Unit System | Metric |

Load Capacities

| | |
|---------------------|----------|
| Static Radial Load | 55,780 n |
| Dynamic Radial Load | 19,170 n |

Interchange

Silverthin [SM36013CP0](#) Kaydon [K36013CP0](#) Kaydon [K36013CP0](#)

Brass; snapover separator

1/4" balls

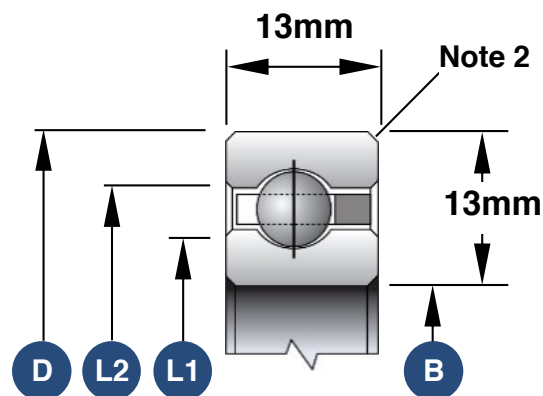

1. Load capacities are not additive
2. The maximum shaft or housing fillet radius that the bearing corners will clear for this series is 1.5mm
3. Race Width Tolerance: +0.000 -0.127mm

Also Available

| | |
|------------------------------|----------------------------|
| Open Angular Contact | SM36013AR0 |
| Open 4-Point Contact | SM36013XP0 |
| Open Duplexed (Back-to-Back) | SM36013BR0 |
| Open Duplexed (Face-to-Face) | SM36013FR0 |

866.294.5841

425.222.7535

sales@silverthin.com

8152 - 304th Ave. S.E. PO Box 5012 Preston, WA 98050-5012 USA

Copyright © 2024 All rights reserved by Silverthin