

SILVERTHIN SM36020ARO 360 mm Open Type A Thin Section Bearing

Specifications

| | |
|---------------------------------|-----------------------------------|
| Bore (B) | 360.000 mm |
| Outside Diameter (D) | 400.000 mm |
| Width | 20mm |
| Land Diameter (L ₁) | 375.000 mm |
| Land Diameter (L ₂) | 385.000 mm |
| Land Diameter (L ₃) | 390.000 mm |
| Approximate Weight | 2.70 kg |
| Separator | Brass; one piece pocket separator |
| Precision Class | ABEC Class 1 |
| Bearing Type | Angular Contact (Type A) |
| Seals, Shields | None (Open) |
| Unit System | Metric |

Load Capacities

| | |
|---------------------|-----------|
| Static Radial Load | 102,505 n |
| Dynamic Radial Load | 36,140 n |
| Static Thrust Load | 295,925 n |
| Dynamic Thrust Load | 91,205 n |

Interchange

Silverthin [SM36020ARO](#) Kaydon [K36020ARO](#) Kaydon [K36020ARO](#)

Brass; one piece pocket separator
3/8" balls

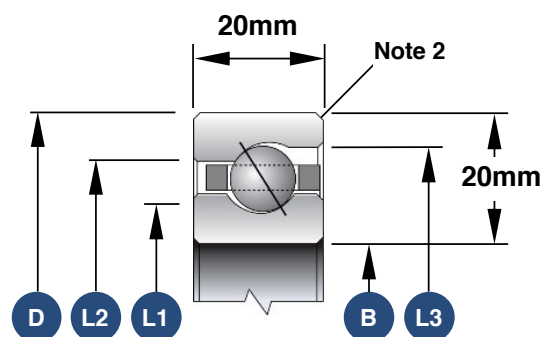

1. Load capacities are not additive
2. The maximum shaft or housing fillet radius that the bearing corners will clear for this series is 1.5mm
3. Race Width Tolerance: +0.000 -0.127mm

Also Available

| | |
|------------------------------|----------------------------|
| Open Radial Contact | SM36020CP0 |
| Open 4-Point Contact | SM36020XP0 |
| Open Duplexed (Back-to-Back) | SM36020BR0 |
| Open Duplexed (Face-to-Face) | SM36020FR0 |